

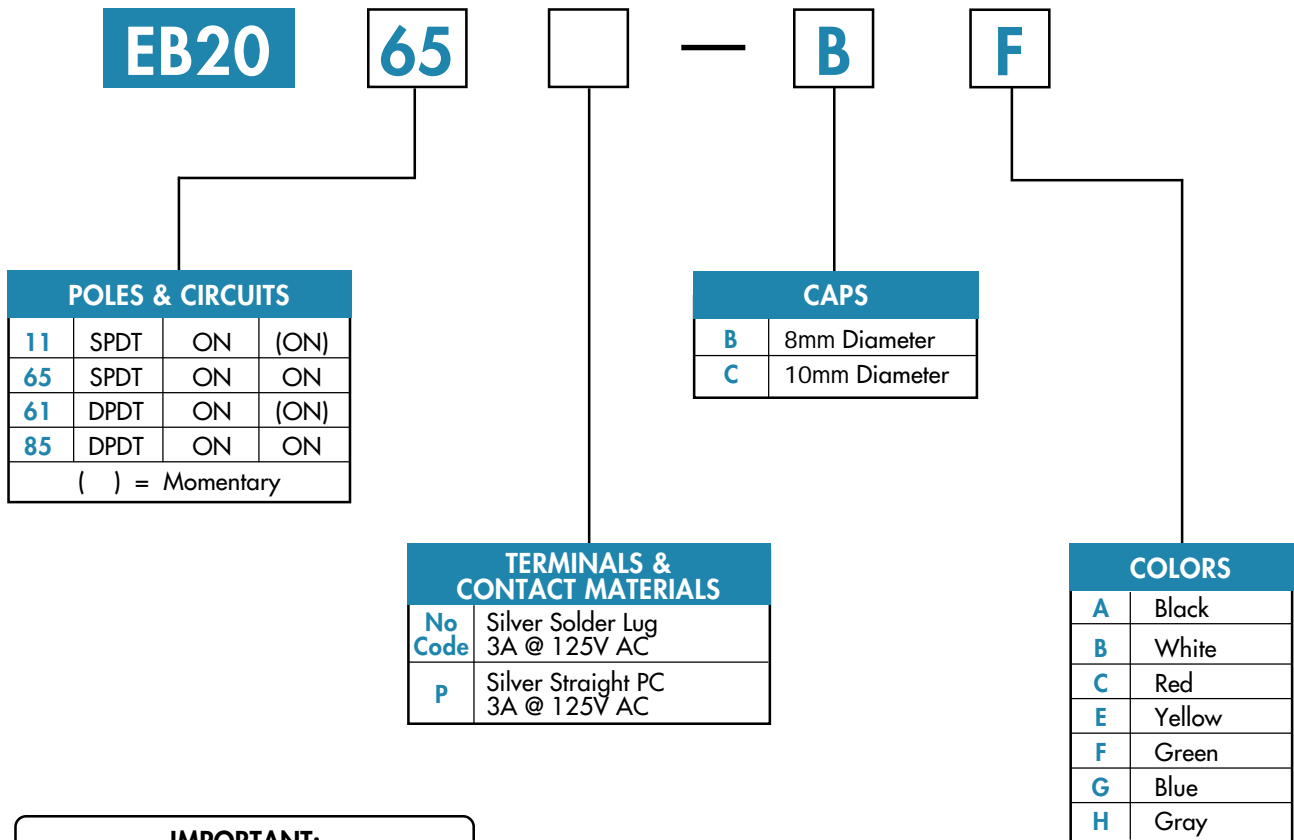

## TYPICAL SWITCH ORDERING EXAMPLE



**IMPORTANT:**



Switches are supplied without UL & CSA marking unless specified. Specific models & ratings noted on General Specifications page.

### DESCRIPTION FOR TYPICAL ORDERING EXAMPLE

**EB2065-BF**





### GENERAL SPECIFICATIONS

#### Electrical Capacity (Resistive Load)

**Power Level (code W):** 3A @ 125V AC

#### Other Ratings

**Contact Resistance:** 10 milliohms maximum  
**Insulation Resistance:** 1,000 megohms minimum @ 500V DC  
**Dielectric Strength:** 1,000V AC minimum between contacts  
1,500V AC minimum between contacts & case  
**Mechanical Life:** 100,000 operations minimum  
**Electrical Life:** 25,000 operations minimum for silver  
**Nominal Operating Force:** Single Pole: 240 grams for momentary & 270 grams for alternate action  
Double Pole: 300 grams for momentary & 370 grams for alternate action  
**Pretravel:** 0.47mm (.019") for Momentary & 1.5mm (.059") for Alternate Action  
**Overtravel:** 1.13mm (.044") for Momentary & 0.7mm (.028") for Alternate Action  
**Total Travel:** 1.6mm (.063") for Momentary & 2.2mm (.087") for Alternate Action

#### Materials & Finishes

**Plunger:** Brass with chrome plating for Momentary; brass with nickel plating for Alternate  
**Bushing:** Brass with nickel plating  
**Frame:** Stainless steel  
**Case:** Diallyl phthalate resin  
**Movable Contacts:** Copper with silver plating  
**Stationary Contacts:** Silver with silver plating  
**Terminals:** Copper with silver plating

#### Environmental Data

**Operating Temp Range:** -10°C through +70°C (+14°F through +158°F)  
**Humidity:** 93% humidity for 96 hours @ 40°C (104°F)  
**Vibration:** 10 ~ 55Hz with peak-to-peak amplitude of 1.5mm traversing the frequency range & returning in 1 minute; 3 right angled directions for 2 hours  
**Shock:** 50g acceleration (tested in 6 right angled directions, with 5 shocks in each direction)

#### Installation

**Mounting Torque:** 15kgf/cm (13lb/in) for double nut; 7kgf/cm (6lb/in) for single nut  
**Cap Installation Force:** 8 kg (17.6 lb) maximum downward force on actuator  
**Soldering Time & Temperature:** 3 seconds @ 350°C or 5 seconds @ 270°C

#### Standards & Certifications





**Flammability Standards:** UL94V-0 rated case  
**UL Recognized:** All single & double pole models recognized at 3A @ 125V AC; UL File No. E44145  
**CSA Certified:** Single pole solder lug & straight PC models certified at 3A @ 125V AC;  
Double pole straight PC models certified at 3A @ 125V AC; CSA File No. LR23535



# Series E

## Light Touch Miniature Pushbutton Switches

### POLES & CIRCUITS

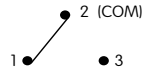
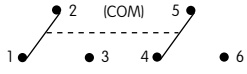
		Plunger Position ( ) = Momentary		Connected Terminals		Throw & Schematics
Pole	Model	Normal  Keyway	Down 	Normal  Keyway	Down 	Note: Terminal numbers are not actually on the switch.
SP	<b>EB2011</b> <b>EB2065</b>	ON ON	(ON) ON	2-3	2-1	SPDT 
DP	<b>EB2061</b> <b>EB2085</b>	ON ON	(ON) ON	2-3 5-6	2-1 5-4	DPDT 

### TERMINALS, CONTACT MATERIALS, & RATINGS

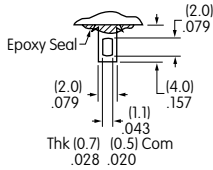
<b>No Code</b>	<b>Solder Lug</b> <b>Silver Contacts</b> Power Level	<b>3A @ 125V AC</b>		<b>Wiring</b> The .043" x .079" oblong hole accommodates one solid 18-gauge wire or two solid or stranded 20-gauge wires.
Single Pole	Double Pole			

### CAPS & COLORS

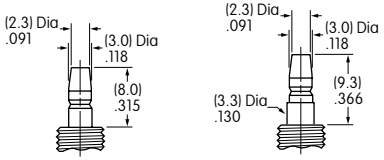
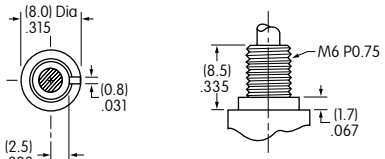
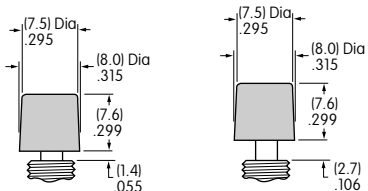
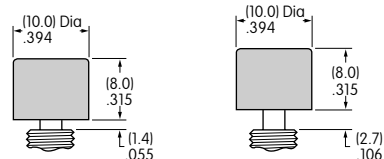
<p><b>Standard Plungers</b></p>  <p>Momentary      Alternate</p> <p><b>Metric Bushing</b></p> 	<p><b>B AT443</b> 8mm Diameter Snap-on Cap</p>  <p>Momentary      Alternate</p> <p>Cap Material: Polycarbonate Finish: Glossy</p>	<p><b>C AT442</b> 10mm Diameter Snap-on Cap</p>  <p>Momentary      Alternate</p> <p>Cap Material: Polycarbonate Finish: Glossy</p>
<p><b>Colors Available:</b></p> <p><b>A</b> Black   <b>B</b> White   <b>C</b> Red   <b>E</b> Yellow   <b>F</b> Green   <b>G</b> Blue   <b>H</b> Gray</p>		

### TYPICAL SWITCH DIMENSIONS

#### Solder Lug



EB2011-BA

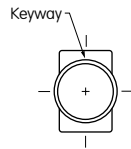

#### Single Pole

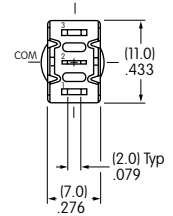
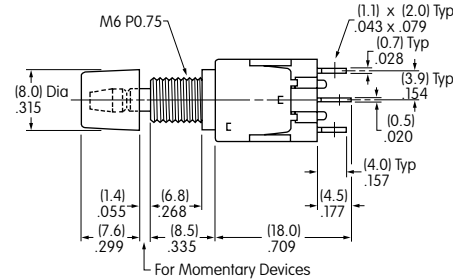

#### Solder Lug



EB2061-BA

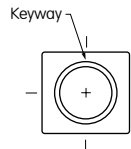

#### Double Pole

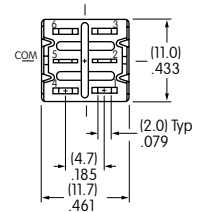
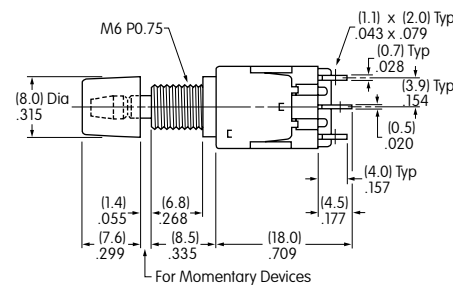

### HARDWARE

Standard Hardware:  
2 AT513M Metric Hexagon Nuts  
1 AT509 Internal Tooth Lockwasher

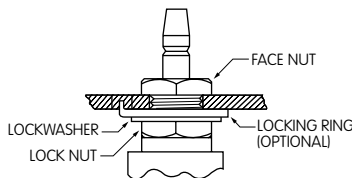

Optional Hardware:  
Locking Ring AT507M

Note: Cap must be snapped on after the switch is mounted into the panel.

#### Standard Hardware

**AT513M Metric Hexagon Nut**

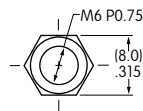

Material:  
Nickel/Brass

**AT509 Lockwasher**

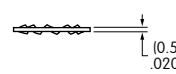
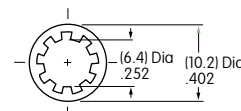

Material:  
Steel with Chromate/Zinc

#### Optional Hardware

**AT507M Metric Locking Ring**

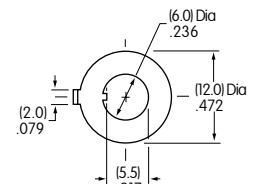

Material:  
Steel with Chromate/Zinc

#### Panel Thicknesses & Panel Cutouts

##### With Standard Hardware

Maximum Effective Panel Thickness:  
3.0mm (.118")

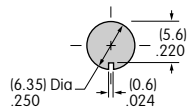

##### Without Bottom Hex Nut

Maximum Effective Panel Thickness:  
4.7mm (.185")

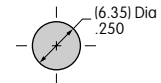

See Accessories & Hardware section for optional Conical Nuts  
AT512M used with cap AT443 and AT512CM used with cap AT442.