



TYPICAL SWITCH ORDERING EXAMPLE

G3B **1** **5** **A** **B** — — — — —

POLES	
1	SPDT
2	DPDT

MOUNTING	
P	Upright
B	Upright with Bracket
H	Right Angle

PACKAGING	
R	Tape-Reel for Right Angle Only 500 Pieces/Reel
S	Stick-Tube for Upright Mount 50 Pieces/Stick
No Code	Partitioned Tray for Upright & Right Angle Any Quantity

OPTIONAL SLIP-ON CAP	
X	.157" Diameter

If code R or S packaging is selected, the switch is supplied with a process compatible cap.

CIRCUITS	
5	ON (ON)
()	= Momentary

DESCRIPTION FOR TYPICAL ORDERING EXAMPLE
G3B15AB

PLUNGER	
A	3.3mm Long

3.3mm Plunger

Packaged in Partitioned Tray

COLORS	
A	Black
B	White
C	Red

■ General Specifications ■ Dimensions

POLES & CIRCUITS

Pole	Model	Plunger Position () = Momentary		Connected Terminals		Throw & Schematics
		Normal	Down	Normal	Down	
SP	G3B15	ON	(ON)	2-3	2-1	SPDT Note: Terminal numbers are not actually on the switch.
DP	G3B25	ON	(ON)	2-3 5-6	2-1 5-4	DPDT

PLUNGER & OPTIONAL SLIP-ON CAP

A 3.3mm Long Plunger

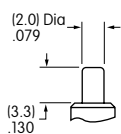

X 4mm Diameter Cap

- AT4063 Material: Polyamide
- Note: Process compatible cap available only with tape-reel or stick-tube packaging.

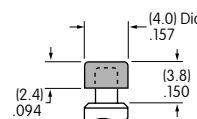

Cap Colors Available:

- A** Black
- B** White
- C** Red



GENERAL SPECIFICATIONS

Electrical Capacity (Resistive Load)

Logic Level: 0.4VA maximum @ 28V AC/DC maximum
(Applicable Range 0.1mA ~ 0.1A @ 20mV ~ 28V)

Note: See [Supplement Index](#) to find explanation of operating range.

Other Ratings

Contact Resistance: 80 milliohms maximum
Insulation Resistance: 500 megohms minimum @ 500V DC
Dielectric Strength: 500V AC minimum
Mechanical Life: 50,000 operations minimum
Electrical Life: 50,000 operations minimum
Nominal Operating Force: Toggles: 95 grams for momentary & 122 grams for maintained
Pushbuttons: 183 grams
Toggle Angle of Throw: 28°
Pushbutton Travel: Pretravel 0.6mm (.024") Overtravel 0.5mm (.019") Total 1.1mm (.043")

Materials & Finishes

Actuator for Toggles: Glass fiber reinforced polyamide
Actuator for Pushbuttons: Polyacetal
Case: Glass fiber reinforced polyamide
Sealing Rings: Nitrile butadiene rubber
Movable Contacts: Phosphor bronze with gold plating over nickel
Stationary Contacts: Phosphor bronze with gold plating over nickel
Base: Glass fiber reinforced polyamide
Terminals: Phosphor bronze with gold plating over nickel

Environmental Data

Operating Temp Range: -30°C through +85°C (-22°F through +185°F)
Humidity: 90 ~ 95% humidity for 96 hours @ 40°C (104°F)
Vibration: 10 ~ 500Hz with peak-to-peak amplitude of 1.5mm traversing the frequency range and returning in 1 minute; 3 right angled directions for 2 hours
Shock: 50g acceleration (tested in 6 right angled directions, with 5 shocks in each direction)

Installation

Mounting: It is recommended that the body of models for upright mounting without bracket be fastened to a panel or similar support for protection of solder joints from mechanical stress.

Soldering Time & Temperature: Vapor Phase Reflow Soldering: 60 seconds @ 150°C + 60 seconds @ 215°C (120 seconds total). Switches should be left in unheated state at least 10 minutes after soldering before they are washed.
Infrared Reflow Soldering: Preheat for 60 seconds @ 150°C (heat rise 1-5°C/second)
Soldering for 10 seconds @ 220°C
Manual Soldering: 3 seconds @ 350°C or 5 seconds @ 260°C
Eutectic solder is recommended.

Process Seal: See [Supplement Index](#) for specific processing data.



Series G

Washable Ultra-Miniature Switches

TYPICAL SWITCH DIMENSIONS

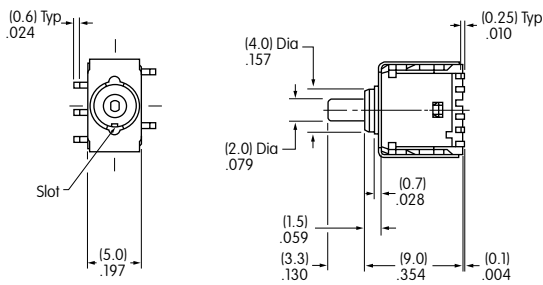

Single & Double Pole

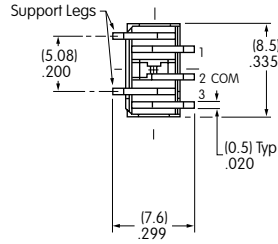

Upright Mounting

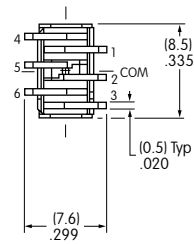

G3B25AP

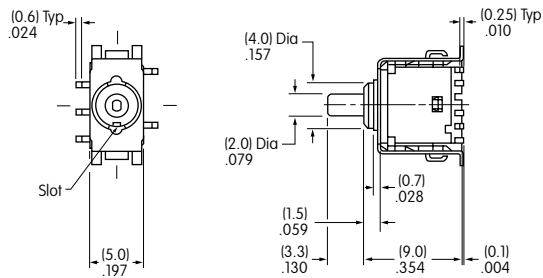

Single & Double Pole

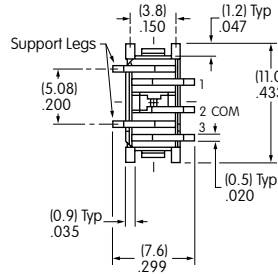

Upright Mounting with Bracket

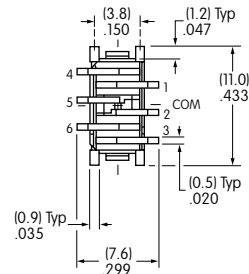

G3B15AB

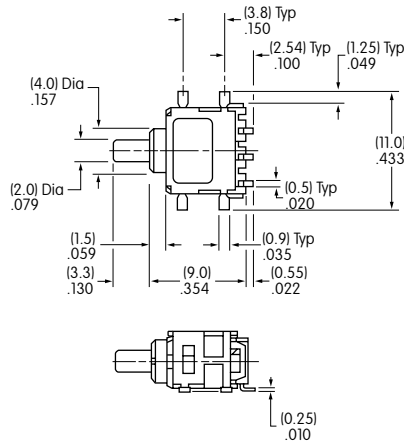

Right Angle Mounting



G3B15AH

Single Pole

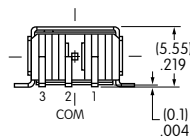

Double Pole

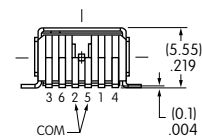

Pad Layouts for Surface Mount Terminals

Single Pole Double Throw

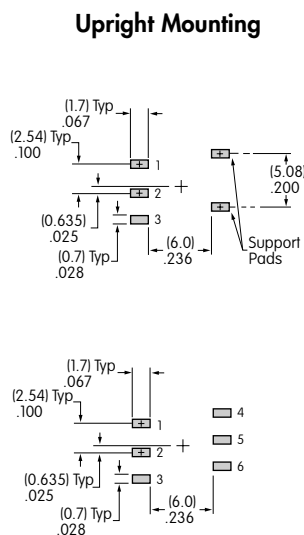

Double Pole Double Throw

Upright Mounting with Bracket

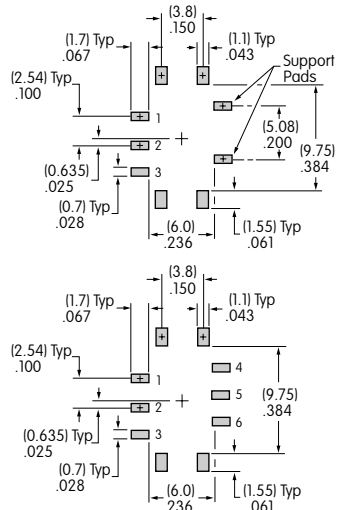

Right Angle Mounting

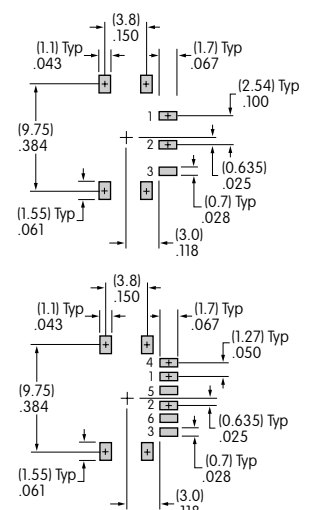



PACKAGING FOR SURFACE MOUNT DEVICES

Tape-Reel Packaging

R **Tape-Reel
for Right Angle Only 500 Pieces/Reel**

Switches must be ordered in 500-piece increments when tape-reel packaging is selected.

This packaging meets EIA-481-2 Standard for "16mm and 24mm Embossed Carrier Taping of Surface Mount Components for Automatic Handling."

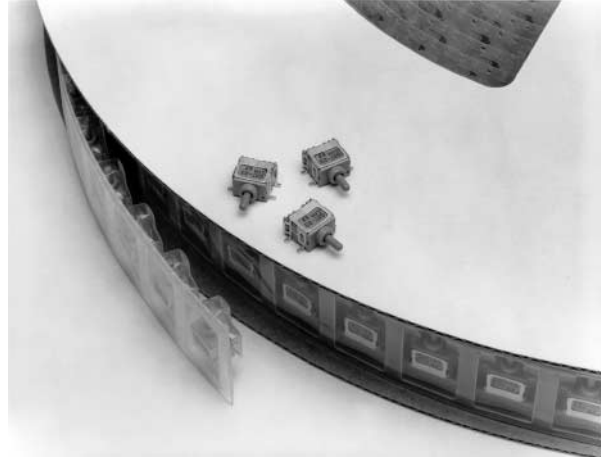

Stick-Tube Packaging

S **Stick-Tube
for Upright Mount 50 Pieces/Stick**

Switches must be ordered in 50-piece increments when stick-tube packaging is selected.

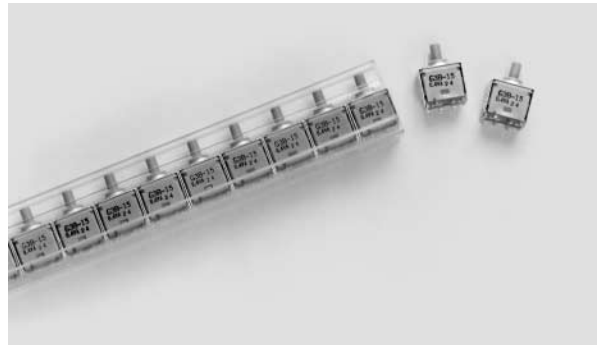

Partitioned Tray

**No
Code** **Partitioned Tray
for Upright & Right Angle
Any Quantity**

If the G3 upright models are ordered in less than 50-piece increments or the right angled models in less than 500-piece increments, the switches are packaged in a partitioned tray. No code is required.



PACKAGING FOR SURFACE MOUNT DEVICES (CONTINUED)

Tape Reel Packaging for G3T Toggle Switches (Right Angle Mount)

Each tape-reel of 550 pockets contains 500 switches.
 Minimum Leader Length: 200mm (7.87") Minimum Trailer Length: 50mm (1.97")

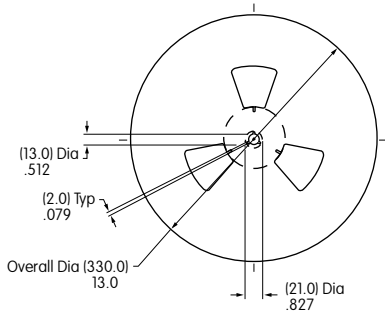

Reel Dimensions

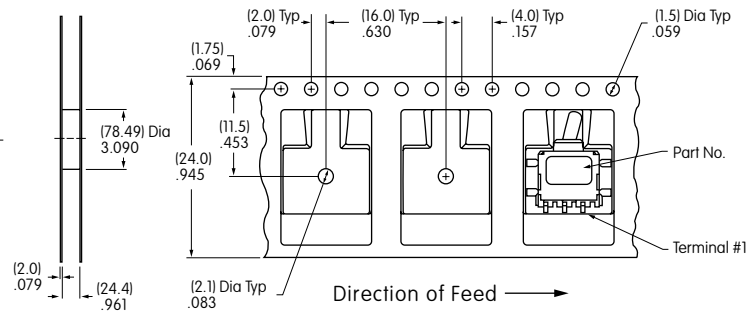

Tape Dimensions

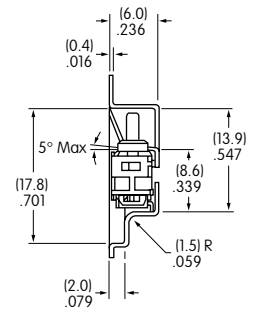

Tape Reel Packaging for G3B Pushbutton Switches (Right Angle Mount)

Each tape-reel of 550 pockets contains 500 switches.
 Minimum Leader Length: 200mm (7.87") Minimum Trailer Length: 50mm (1.97")

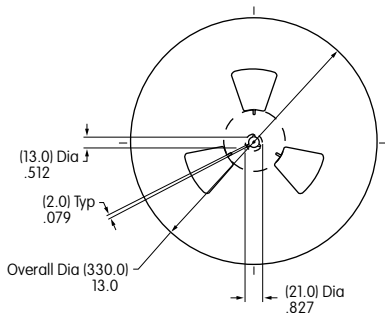

Reel Dimensions

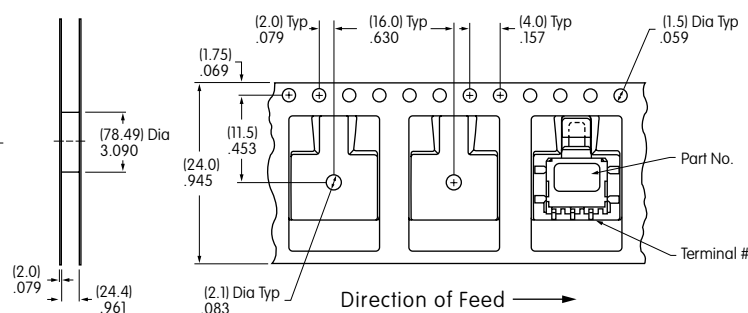

Tape Dimensions

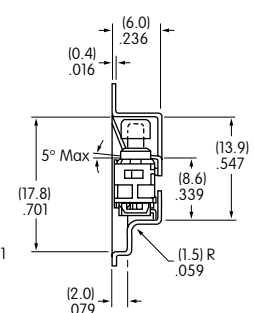

Stick-tube Packaging for G3T Toggle & G3B Pushbutton Switches (Upright Mount)

Each stick-tube contains 50 switches.

Length

- G3T Upright (code P):
450mm (17.72")
- G3T Upright with Bracket (code B):
520mm (20.47")
- G3B Upright (code P):
450mm (17.72")
- G3B Upright with Bracket (code B):
525mm (20.67")

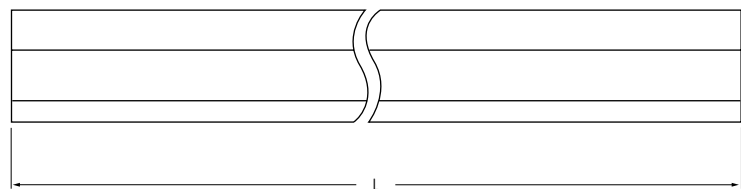
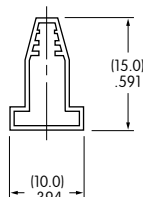

Stick-tube Dimensions