

TYPICAL SWITCH ORDERING EXAMPLE

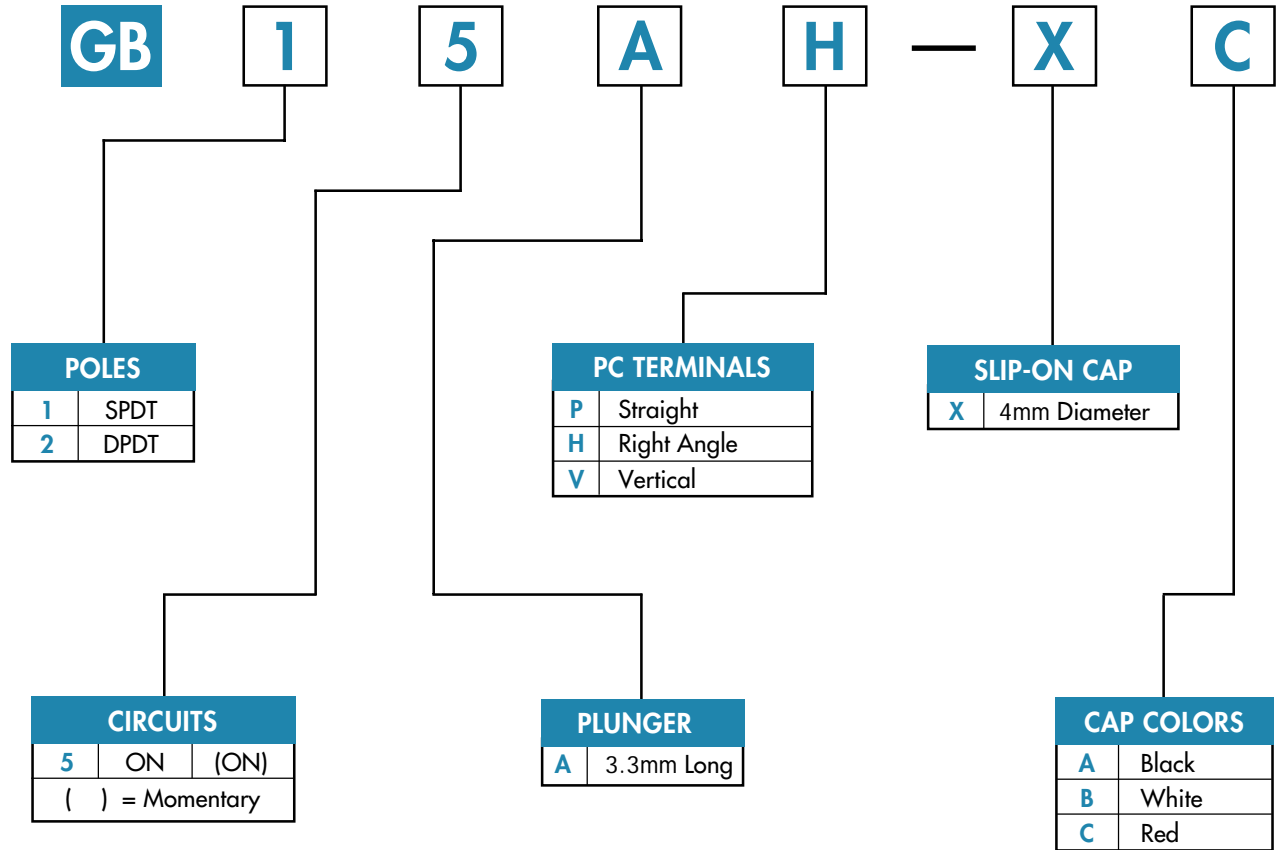

DESCRIPTION FOR TYPICAL ORDERING EXAMPLE

GB15AH-XC





GENERAL SPECIFICATIONS

Electrical Capacity (Resistive Load)

Logic Level: 0.4VA maximum @ 28V AC/DC maximum
(Applicable Range 0.1mA ~ 0.1A @ 20mV ~ 28V)
Note: See [Supplement Index](#) to find explanation of operating range.

Other Ratings

Contact Resistance: 80 milliohms maximum
Insulation Resistance: 500 megohms minimum @ 500V DC
Dielectric Strength: 500V AC minimum
Mechanical Life: 100,000 operations minimum for On-None-On & On-Off-On
50,000 operations minimum for other circuits
Electrical Life: 100,000 operations minimum for On-None-On & On-Off-On
50,000 operations minimum for other circuits
Nominal Operating Force: Toggles: 95 grams for momentary & 122 grams for maintained
Rockers: 83 grams for momentary & 108 grams for maintained
Pushbuttons: 200 grams
Contact Bounce: 1 millisecond
Toggle & Rocker Angle of Throw: 28°
Pushbutton Travel: Pretravel 0.9mm (.035") Overtravel 0.2mm (.008") Total 1.1mm (.043")

Materials & Finishes

Actuator for Toggles & Rockers: Glass fiber reinforced polyamide
Actuator for Pushbuttons: Polyacetal
Case: Glass fiber reinforced polyamide
Sealing Rings: Nitrile butadiene rubber
Movable Contacts: Phosphor bronze with gold plating over nickel
Stationary Contacts: Phosphor bronze with gold plating over nickel
Base: Glass fiber reinforced polyamide
Terminals: Phosphor bronze with gold plating over nickel

Environmental Data

Operating Temp Range: -30°C through +85°C (-22°F through +185°F) for toggles & rockers
-40°C through +85°C (-40°F through +185°F) for pushbuttons
Humidity: 90 ~ 95% humidity for 96 hours @ 40°C (104°F)
Vibration: 10 ~ 500Hz with peak-to-peak amplitude of 1.5mm traversing the frequency range
& returning in 1 minute; 3 right angled directions for 2 hours
Shock: 50g acceleration (tested in 6 right angled directions, with 5 shocks in each direction)

Installation

Soldering Time & Temperature: 3 seconds @ 350°C or 5 seconds @ 270°C
Process Seal: See [Supplement Index](#) for specific processing data.

Standards & Certifications





IECQ Approved: All toggle & pushbutton models recognized at 0.4VA maximum @ 28V AC/DC maximum
Qualification Approval Numbers:
G Toggle Switches JP792-7A
GB Pushbutton Switches JP792-6A

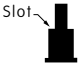

Series G

Washable Ultra-Miniature Switches

POLES & CIRCUITS

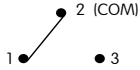
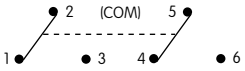
		Plunger Position () = Momentary		Connected Terminals		Throw & Schematics
Pole	Model	Normal 	Down 	Normal 	Down 	Note: Terminal numbers are not actually on the switch.
SP	GB15	ON	(ON)	2-3	2-1	SPDT 
DP	GB25	ON	(ON)	2-3 5-6	2-1 5-4	DPDT 

PLUNGER

A 3.3mm Long Plunger

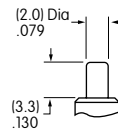

PC TERMINALS

P Straight

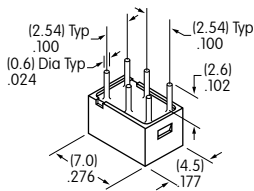

H Right Angle

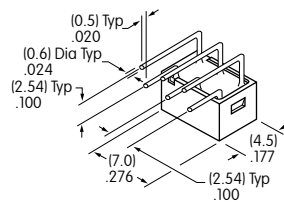

V Vertical

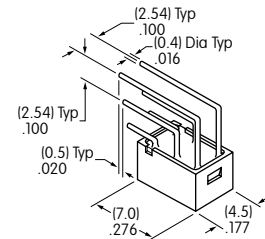

SLIP-ON CAP & COLORS

X AT4063
4mm Diameter Slip-on Cap

Material: Polyamide

Finish: Glossy



Actual Size

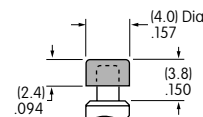

Cap Colors Available:

A Black

B White

C Red



TYPICAL SWITCH DIMENSIONS

Straight PC

Single & Double Pole

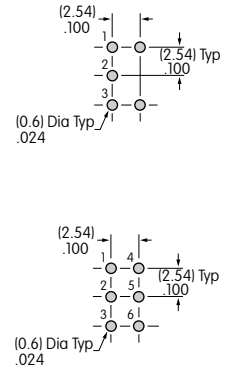
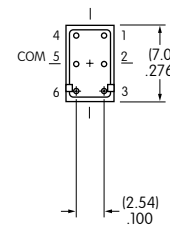
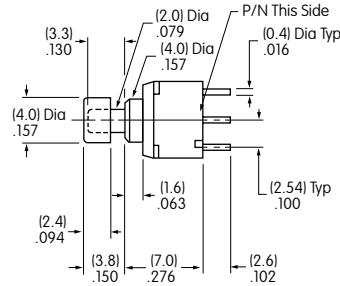
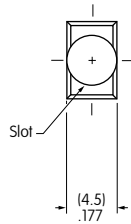

GB25AP-XC

On single pole switches terminals 4 & 6 are support pins.

Right Angle PC

Single & Double Pole

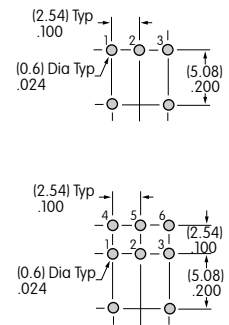
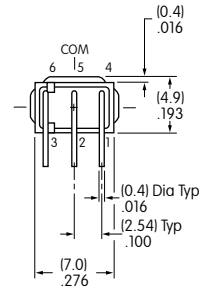
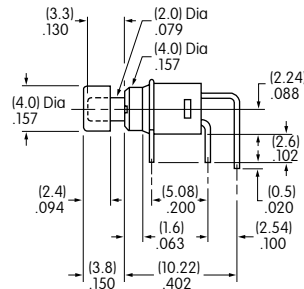
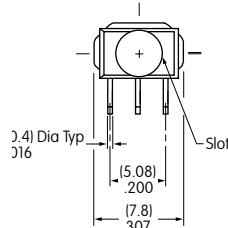

GB25AH-XC

Vertical PC

Single & Double Pole

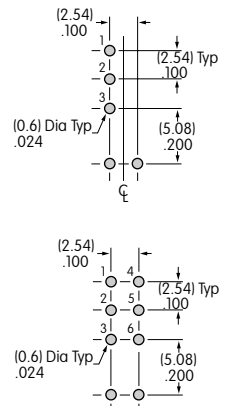
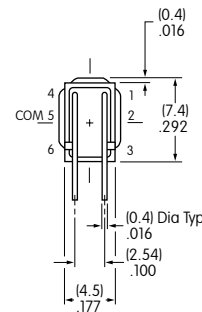
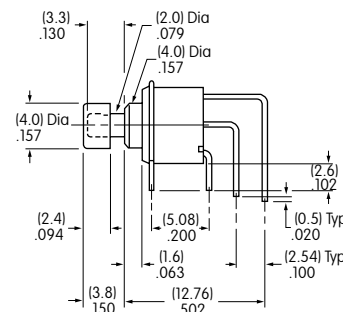
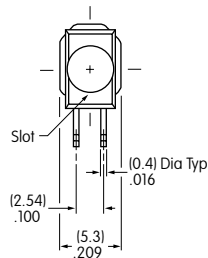

GB25AV-XC