



Series SB

Low/Medium Capacity Pushbutton Switches

GENERAL SPECIFICATIONS FOR SB25, SB60s, SB200s

Electrical Capacity (Resistive & Inductive Load)

Power Level: Shown in the following tables

Other Ratings

| | |
|-------------------------------|--------------------------------------------------------------------------------------------------------------------------------------------------|
| Contact Resistance: | 10 milliohms maximum |
| Insulation Resistance: | 200 megohms minimum @ 500V DC for SB220s, SB265s, SB285; 1,000 megohms minimum @ 500V DC for SB60s; 100 megohms minimum @ 500V DC for SB25s |
| Dielectric Strength: | 1,500V AC minimum for SB265s, SB285, & SB25s 2,000V AC minimum between contacts; 1,500V AC minimum between contacts & case for SB220s & SB60s |
| Mechanical Life: | 50,000 operations minimum for SB220s; 30,000 operations minimum for SB25s, SB60s, SB265s, SB285 |
| Electrical Life: | 10,000 operations minimum |
| Total Travel: | SB220s 2.95mm (.116"); SB60s 2.4mm (.094"); SB265 5.4mm (.213"); SB285 & SB25s 4.95mm (.195") |
| Operating Temp Range: | -10°C through +70°C (+14°F through +158°F) |





Materials & Finishes

| | |
|-------------------------------------------|----------------------------------------------------------------------------------------------------|
| Cap: | Polybutylene terephthalate (AT414) |
| Plunger: | Polyacetal or brass with nickel plating |
| Bushing: | Brass with nickel plating |
| Case: | Phenolic resin or melamine phenolic resin |
| Case Cover: | Steel with zinc plating |
| Movable & Stationary Contacts: | Copper with silver plating for SB220s; silver alloy with silver plating for SB25s, SB60s, & SB200s |
| Terminals: | Brass or copper with silver plating |



Standards & Certifications

| | |
|-----------------------|---------------------------------------------------------------------------------------------------------------------------------------------------------------------------------------------------------------------------------|
| UL Recognized: | Designated with UL recognized symbol beside part numbers on following pages See Supplement Index to find UL rating details. UL File No. E44145 Add "/U" to end of part number to order UL mark on switch. |
| CSA Certified: | Designated with CSA certified symbol beside part numbers on following pages See Supplement Index to find UL rating details. CSA File No. LR23535 |

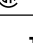
SINGLE POLE WITH SOLDER LUG OR SCREW LUG

| Model | Approvals | Pole & Throw | Pushbutton Position/Connected Terminals () = Momentary | | Electrical Capacity (Resistive) | |
|-----------|---------------------------------------------------------------------------------------|--------------|--------------------------------------------------------------------------------------------|--------------------------------------------------------------------------------------------|---------------------------------|---------|
| | | | Normal  | Down  | AC 125V | AC 250V |
| SB221NO | —  | SPST | OFF — | (ON) 1-4 | 3A | 1.5A |
| SB221NC |  | SPST | ON 1-4 | (OFF) — | 3A | 1.5A |
| SB221TNO* | —  | SPST | OFF — | (ON) 1-4 | 3A | 1.5A |
| SB221TNC* |  | SPST | ON 1-4 | (OFF) — | 3A | 1.5A |

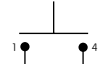
* Suffix T = Screw Lug

Throw & Schematic: SPST SB221NO  SPST SB221NC 

Note: Terminal numbers are on the switch.

- Standard Hardware: AT504 Knurled Nut, AT508 Lockwasher, AT527 Hex Backup Nut. See [Accessories & Hardware Index](#) for details.
- Solder lug terminal hole accommodates one 12-gauge solid or stranded wire.



SB221NO
Supplied w/AT414 Black Cap

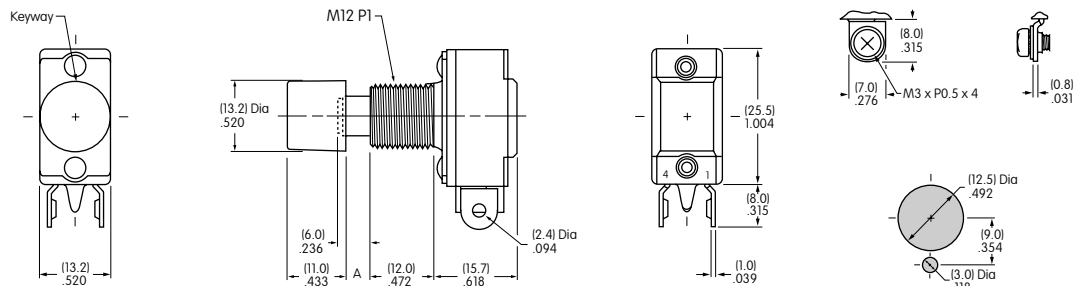

Dimension A: 4.7mm (.185") for NO model & 3.8mm (.150") for NC model.

Panel Thickness:
4.9mm (.193")



Series SB

Low/Medium Capacity Pushbutton Switches

DOUBLE POLE WITH SOLDER LUG

| | | | Pushbutton Position/Connected Terminals () = Momentary | | Electrical Capacity | |
|--------|-----------|--------------|---------------------------------------------------------|-----------------------------|---------------------|---------|
| Model | Approvals | Pole & Throw | Normal | Down | Resistive | |
| | | | Keyway | | AC 125V | AC 250V |
| SB61A | — | DPDT | ON 2-3 5-6 | (ON) 2-1 5-4 | 10A | 5A |
| SB61B | — — | DPDT | ON 2-3 5-6 | (ON) 2-1 5-4 | 3A | 1.5A |
| SB63A* | — — | DPDT | ON 2-3 5-6 | (ON) or Lockdown ON 2-1 5-4 | 10A | 5A |

* Lockdown for SB63A is achieved by actuating & then turning the button clockwise.

Throw & Schematic: DPDT

Notes: Terminal numbers are on the switch.

- Standard Hardware: AT504 Knurled Nut, AT508 Lockwasher, AT527 Hex Backup Nut. See [Accessories & Hardware Index](#) for details.
- Solder lug terminal hole accommodates one 12-gauge solid or stranded wire.

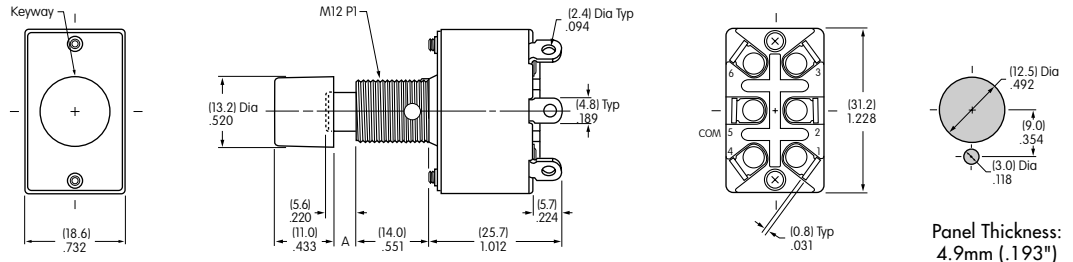

SB61A

Supplied w/AT414 Black Cap

Dimension A: 4.3mm (.169") for SB61 model & 3.3mm (.130") for SB63 model.

DOUBLE POLE WITH SOLDER LUG

| | | | Pushbutton Position/Connected Terminals () = Momentary | | Electrical Capacity | |
|-------|-----------|--------------|---------------------------------------------------------|------------|---------------------|---------|
| Model | Approvals | Pole & Throw | Normal | Down | Resistive | |
| | | | Keyway | | AC 125V | AC 250V |
| SB25 | | DPDT | ON 2-3 5-6 | ON 2-1 5-4 | 15A | 9A |
| SB25B | — — | DPDT | ON 2-3 5-6 | ON 2-1 5-4 | 5A | 3A |

Throw & Schematic: DPDT

Note: Terminal numbers are on the switch.

- Standard Hardware: AT504 Knurled Nut, AT508 Lockwasher, AT527 Hex Backup Nut. See [Accessories & Hardware Index](#) for details.
- Solder lug terminal hole accommodates one 12-gauge solid or stranded wire.

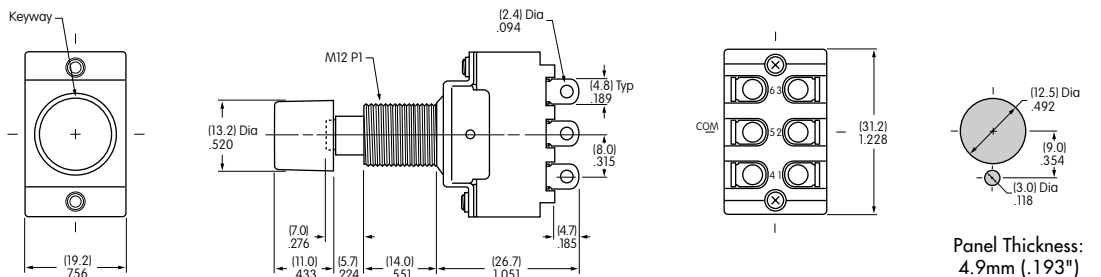

SB25





Supplied w/AT414 Black Cap

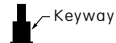

Series SB

Low/Medium Capacity Pushbutton Switches

SINGLE POLE WITH SOLDER LUG

| | | | Pushbutton Position/Connected Terminals () = Momentary | | Electrical Capacity | |
|----------------------------------------------------------------------------------------------------------------------|-----------------------------------------------------------------------------------|--------------|------------------------------------------------------------------------------------------|-----------------------------------------------------------------------------------|-------------------------------------------|---------|
| Model | Approvals | Pole & Throw | Normal | Down | Resistive | |
| | | |  Keyway |  | AC 125V | AC 250V |
| SB265 |  | SPST | ON 1-4 | OFF - | 6A | 3A |
| Throw & Schematic: SPST  | | | | | Note: Terminal numbers are on the switch. | |



- Standard Hardware: AT504 Knurled Nut, AT508 Lockwasher, AT527 Hex Backup Nut. See [Accessories & Hardware Index](#) for details.
- Solder lug terminal hole accommodates one 12-gauge solid or stranded wire.

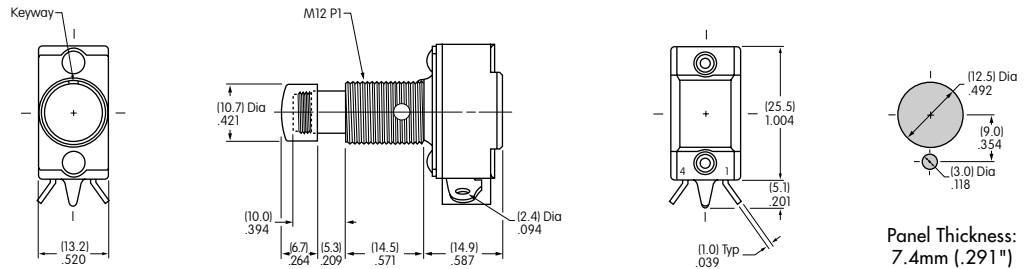

SB265
Supplied with Chrome Plated Brass Cap

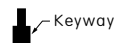

DOUBLE POLE WITH SOLDER LUG

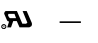
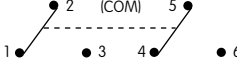
| | | | Pushbutton Position/Connected Terminals () = Momentary | | Electrical Capacity | |
|------------------------------------------------------------------------------------------------------------------------|-------------------------------------------------------------------------------------|--------------|--------------------------------------------------------------------------------------------|-------------------------------------------------------------------------------------|-------------------------------------------|---------|
| Model | Approvals | Pole & Throw | Normal | Down | Resistive | |
| | | |  Keyway |  | AC 125V | AC 250V |
| SB285 |  | DPDT | ON 2-3 5-6 | ON 2-1 5-4 | 6A | 3A |
| Throw & Schematic: DPDT  | | | | | Note: Terminal numbers are on the switch. | |

- Standard Hardware: AT504 Knurled Nut, AT508 Lockwasher, AT527 Hex Backup Nut. See [Accessories & Hardware Index](#) for details.
- Solder lug terminal hole accommodates one 12-gauge solid or stranded wire.



SB285
Supplied with Chrome Plated Brass Cap

