

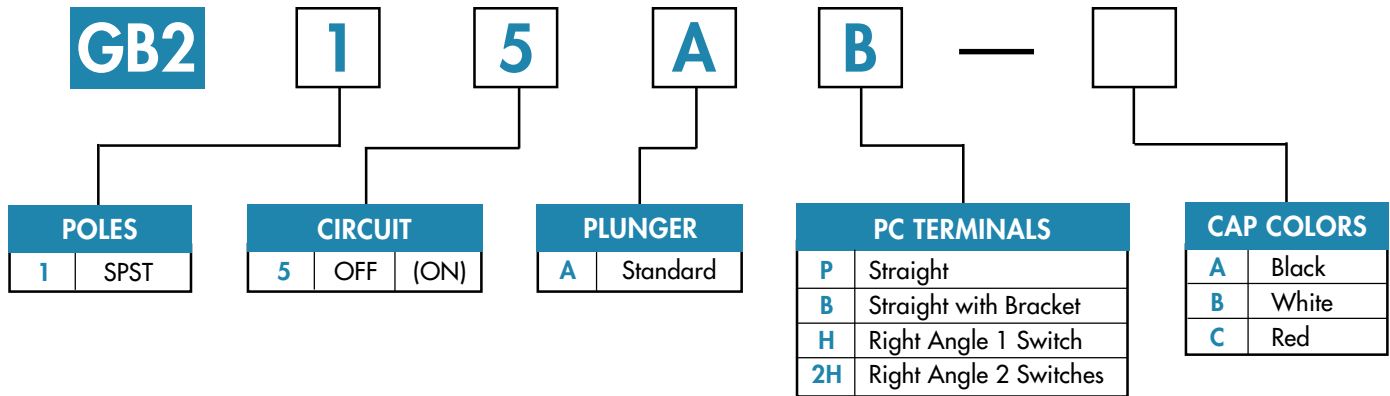

# Series GB2

Ultra-Thin Pushbutton Switches

## TYPICAL SWITCH ORDERING EXAMPLE



DESCRIPTION FOR TYPICAL  
PUSHBUTTON ORDERING EXAMPLE  
**GB215AB**

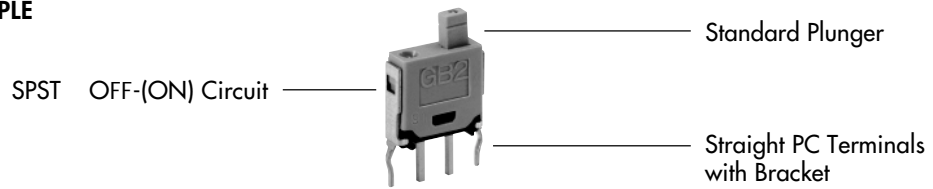

■ General Specifications ■ Dimensions 1 ■ Dimensions 2

## POLES & CIRCUITS

		Plunger Position ( ) = Momentary		Connected Terminals		Throw & Schematics
Pole	Model	Normal	Down	Normal	Down	
SP	GB215	OFF	(ON)	OPEN	1-2	SPST  1 (COM) 2

## TYPICAL SWITCH DIMENSIONS

Straight PC

Single Pole

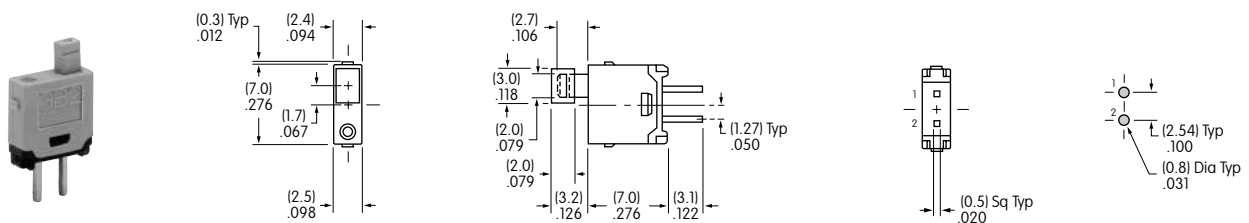

GB215AP



# Series GB2

Ultra-Thin Pushbutton Switches

## TYPICAL SWITCH DIMENSIONS

### Straight PC with Bracket

### Single Pole

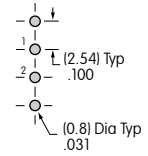
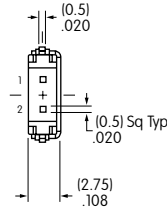
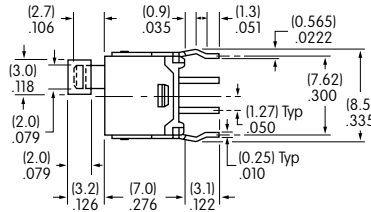
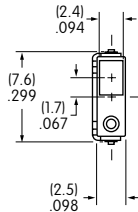

GB215AB

### Right Angle PC

### Single Pole with 1 Switch

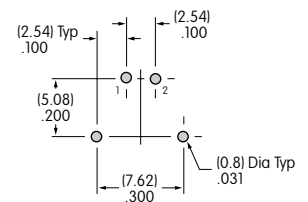
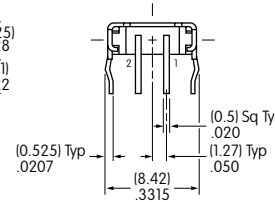
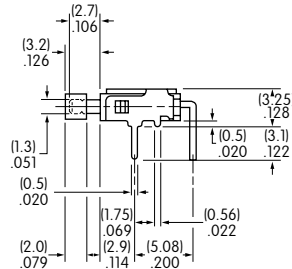
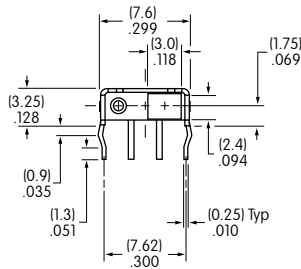

GB215AH

### Right Angle PC

### Single Pole with 2 Switches

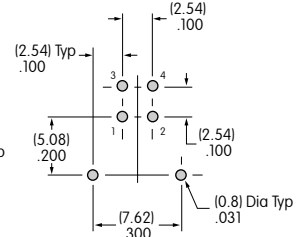
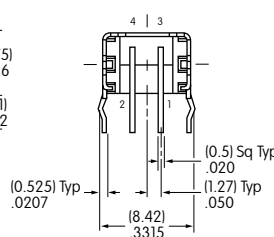
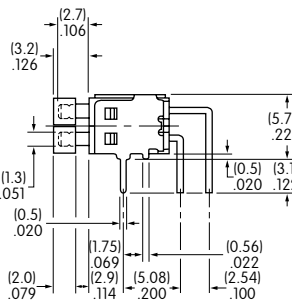
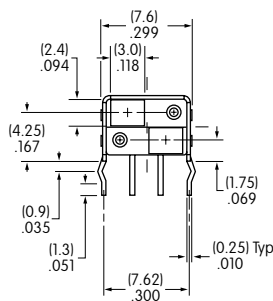

GB215A2H

## OPTIONAL SNAP-ON CAP & MOUNTING BRACKET

**A** AT4137 Rectangular Snap-on Cap Black

**B** AT4137 Rectangular Snap-on Cap White

**C** AT4137 Rectangular Snap-on Cap Red

Material: PBT  
Finish: Glossy



Actual Size

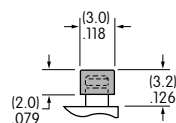

**AT546**  
Mounting Bracket  
for Block Mounting

Material:  
Phosphor Bronze  
with Tin-lead Plating

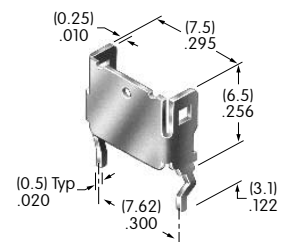

See Engineering Particulars page for further details.



## GENERAL SPECIFICATIONS

### Electrical Capacity (Resistive Load)

**Logic Level:** 0.4VA maximum @ 28V AC/DC maximum  
(Applicable Range 0.1mA ~ 0.1A @ 20mV ~ 28V)  
Note: See Supplement Index (page Z1) to find explanation of operating range.

### Other Ratings

**Contact Resistance:** 80 milliohms maximum  
**Insulation Resistance:** 500 megohms minimum @ 500V DC  
**Dielectric Strength:** 500V AC minimum  
**Mechanical Life:** 50,000 operations minimum  
**Electrical Life:** 50,000 operations minimum  
**Nominal Operating Force:** 101.97 grams  
**Contact Bounce:** 0.5 millisecond  
**Travel:** 0.5mm (.02") pretravel; 1.1mm (.043") total travel

### Materials & Finishes

**Actuator:** Glass fiber reinforced polyamide  
**Case:** Glass fiber reinforced polyamide  
**Sealing Ring:** Acrylonitrile butadiene rubber  
**Movable Contacts:** Phosphor bronze with gold plating over nickel  
**Stationary Contacts:** Phosphor bronze with gold plating over nickel  
**Base:** Glass fiber reinforced polyamide  
**Mounting Bracket:** Phosphor bronze with tin plating  
**Terminals:** Phosphor bronze with gold plating over nickel for straight PC;  
phosphor bronze with tin plating for right angle PC

### Environmental Data

**Operating Temp Range:** -25°C through +70°C (-13°F through +158°F)  
**Humidity:** 93% humidity for 240 hours @ 40°C (104°F)  
**Vibration:** 10 ~ 55Hz with peak-to-peak amplitude of 1.5mm traversing the frequency range & returning in 1 minute; 3 right angled directions for 2 hours  
**Shock:** 50g acceleration (tested in 6 right angled directions, with 5 shocks in each direction)

### Installation

**Soldering Time & Temperature:** 3 seconds @ 350°C or 5 seconds @ 270°C  
**Process Seal:** Not available

### Standards & Certifications

**Flammability Standards:** UL94V-0 actuator & case/base